



HANDEL+HAYDN SOCIETY



HANDEL+HAYDN SOCIETY

**PRIDE** 

# **HANDEL'S WATER MUSIC**

April 10 + 12, 2026

**Stories about the arts.  
And, well, pretty  
much everything.**



**wbur.org**



## **WELCOME TO H+H**



**“music that crackles with  
life and color”**

**– *The Boston Globe***

We are delighted you're here to celebrate community with music. Today's program bursts with energy and splendor! We'll hear the genius of Bach's Brandenburg Concerto No. 1, several sparkling selections from Lully and Rameau (all of which are H+H premieres), and of course Handel's glorious *Water Music*.

Picture this: it's 1717, and King George I is floating down the River Thames on a royal barge while a second barge carrying 50 musicians performs spectacular music. The King commissioned Handel to create *Water Music* for this elaborate outdoor celebration, and over 300 years later, it still makes us want to celebrate! Today, you'll hear why this music has remained such a favorite—from the majestic sound of the horns to the playful, dancing melodies in the strings. It's music that's meant to bring joy, and we hope you leave the hall feeling lighter.

We open today's concert with the inaugural H+H Youth Choruses Chorale Festival, featuring singers from Framingham and Silver Lake Regional High School in their Symphony Hall debut. These talented students worked incredibly hard to prepare for this moment, and I couldn't be prouder of them. Please join us in celebrating the future of music; the next generation of performers is ready to shine!

We also celebrate Pride this weekend. H+H is proud to be part of Boston's vibrant community of musicians and music lovers and to showcase the creativity, resilience, and beautiful diversity of our local LGBTQIA+ community. Music brings us together.

Finally, today is a celebration of you. Whether this is your first H+H concert, or you've been coming for years, we could not perform this music if you were not here to share it. And there is so much more to come! We recently announced our 2026-27 Season that includes beloved works long associated with H+H including Mendelssohn's *Elijah* and Bach's Brandenburg Concertos, as well as a world premiere to be performed with H+H Programming Consultant Reginald Mobley. Our dear friend and Conductor Laureate Harry Christophers will join us for *Messiah*, and we'll introduce you to cellist Nicolas Altstaedt. Please visit our website to learn more about all of next season's programs. We hope to see you in the hall again soon!

**JongHun Kim**  
Director of Learning Programs

Handel and Haydn Society

# TABLE OF CONTENTS

<b>The Handel and Haydn Society</b>	5
<b>Handel's Water Music</b>	6
Program Notes	11
Text	14
Artist Profiles	16
H+H Orchestra	18
HHYC Chorale Festival singers	21
<b>Donors</b>	22
<b>H+H Board</b>	30
<b>H+H Staff</b>	31
<b>Symphony Hall Information</b>	32
<b>General Information</b>	33

# PROGRAM SPONSORS

**This program is made possible through the generous support of Joseph G. Mari.**

Stewart H. Steffey Jr., *sponsor of the H+H Orchestra*  
 Anne & David\* Gergen, *season sponsors of Guy Fishman, cello*  
 Rebecca Nemser, *in memory of Paul Nemser, season sponsor of Sonja DuToit Tengblad, soprano, and Emily Marvosh, alto*

The Learning Program is funded in perpetuity by Karen S. & George D. Levy.

The Handel and Haydn Society is funded in part by the Massachusetts Cultural Council.

The program book is printed by The Graphic Group.

\* Deceased



# THE HANDEL AND HAYDN SOCIETY

Boston's Grammy-winning Handel and Haydn Society performs Baroque and Classical music with a freshness, a vitality, and a creativity that inspires all ages. Called "one of the most exciting ensembles of historically informed performances in the world" (*OperaWire*), H+H has been captivating audiences for 211 consecutive seasons (the most of any performing arts organization in the United States), speaking to its singular success at welcoming new audiences to this extraordinary music, generation after generation.

H+H performed the "Hallelujah" chorus from Handel's *Messiah* in its first concert in 1815, gave the American premiere in 1818, and ever since has been both a musical and a civic leader in the Boston community. During the Civil War, H+H gave numerous concerts in support of the Union Army (H+H member Julia Ward Howe wrote "The Battle Hymn of the Republic") and on January 1, 1863, H+H performed at the Grand Jubilee Concert celebrating the enactment of the Emancipation Proclamation. Two years later, H+H performed at the memorial service for Abraham Lincoln.

H+H's Orchestra and Chorus delight more than 76,000 listeners annually through concerts at Symphony Hall and other leading venues as well as radio broadcasts. Through the Karen S. and George D. Levy Learning and Education Program, H+H supports seven youth choirs of singers in grades 2-12 and provides thousands of complimentary tickets to students and communities throughout Boston, ensuring the joy of music is accessible to all. H+H has released 16 CDs on the CORO label and has toured nationally and internationally.

In all these ways, H+H fulfills its mission to inspire the intellect, touch the heart, elevate the soul, and connect all of us with our shared humanity through transformative experiences with Baroque and Classical music.

## Leadership

Judith K. Verhave  
*Chair, Board of Governors*  
 Carrie L.T. Hammond  
 and Nicholas Dials  
*Co-Chairs, Board of Advisors*  
 David Goldenheim  
*Acting CEO*  
 Robert H. Scott  
*Acting President*

## Artistic

Jonathan Cohen  
*Artistic Director*  
 Ian Watson  
*Associate Conductor*  
 Aisslinn Nosky  
*Concertmaster*  
 Scott Allen Jarrett  
*Resident Conductor, Chorus*  
 Anthony Trecek-King  
*Resident Conductor, Chorus*  
 Reginald Mobley  
*Programming Consultant*  
 Harry Christophers  
*Conductor Laureate*

## Youth Chorus Conductors

Michele Adams  
*Youth Chorale and Concert Choir*  
 Alyson Greer Espinosa  
*Chorus of Sopranos + Altos and Chamber Choir*  
 Dr. Kevin McDonald  
*Chorus of Tenors + Basses*  
 Nurt Villani  
*New Voices and Treble Chorus*

# HANDEL'S WATER MUSIC

Symphony Hall

Friday, April 10, 2026 at 7:30pm

Sunday, April 12, 2026 at 3:00pm

Jonathan Cohen conductor

H+H Orchestra

2,709th Concert

2,711th Concert

## Brandenburg Concerto No. 1 in F Major, BWV 1046

J. S. Bach

Allegro

Adagio

Allegro

Minuetto

## Suite of instrumental dances and overtures

Jean-Philippe Rameau

(1683-1764)

Overture from *Les Indes galantes*

Tambourins I & II from *Les Indes galantes*

Chaconne from *Naïs*

Overture from *Hippolyte et Aricie*

"Entrée des habitants de la forêt" from *Hippolyte et Aricie*

Chaconne from *Dardanus*

Concert runs 2 hours and 10 minutes including intermission.

With deep gratitude for her many years of leadership, partnership, and friendship, H+H dedicates these performances to the memory of Janet Whitla. A tribute to Janet may be found on page 10.

### Coronation Anthem No. 1, *Zadok the Priest*

George Frideric Handel  
(1685-1759)

H+H Youth Choruses Chorale Festival  
Anthony Trecek-King conductor

### Selections from *Le Bourgeois gentilhomme*, LWV 43

Jean-Baptiste Lully  
(1632-1687)

Overture

2eme Air (Gavotte)

Marche pour la cérémonie des Turcs

Entrée des Scaramouches

Chaconne des Scaramouches

### 3 Fugues from *Art of the Fugue*, BWV 1060

Johann Sebastian Bach  
(1685-1750)

Contrapunctus 1

Contrapunctus 4

Contrapunctus 7

### Water Music, Suite No. 1, HWV 348

Handel

Overture: Largo—Allegro

Adagio e staccato

Allegro

Andante espressivo—Allegro

Presto

Air—Presto

Minuet

Bourée—Presto

Hornpipe

Allegro moderato

**INTERMISSION**



Saturday, April 25, 2026, 12pm

Symphony Hall

With Young People's String Orchestra and members of the Intensive Community Program

Marta Žurad, *Conductor*

Matt Roberts, *Magician*

#### TICKETS

Adults \$20, kids under 18 are free (limit four per family).

Visit [www.BYSOweb.org](http://www.BYSOweb.org) or call Symphony Charge at 617-266-1200



BYSO/BSO:  
Partnering for the  
Future

## PERIOD INSTRUMENT SPOTLIGHT THE BASSO CONTINUO

In the Baroque, the basso continuo was the heart of the ensemble. Although the precise instrumentation was often not indicated by the composer, today we will hear a typical basso continuo group consisting of two types of instruments: low strings or bassoon playing the written bassline and a harpsichord or organ to play chords.

In addition to the written bassline, the music for the harpsichord or organ includes a notation system called figured bass. This notation indicates which chords should be played. While following the chord pattern, it is common for the keyboard player to improvise their part, a practice called “realizing the bass.”



## THE WORLD BEYOND



Italian French composer  
Jean-Baptiste Lully  
(1632-1687)



American abolitionist Prince  
Hall (c. 1735-1807)



Rev. Dr. Gardiner  
(1765-1830)

- 1634** Present-day Green Bay, Wisconsin, one of the oldest permanent European settlements in the United States, is founded by Jean Nicolet. French explorers will establish settlements in the Great Lakes region and along the Mississippi River throughout the 17th century.
- 1687** In leading a performance of his *Te Duem* by striking a staff on the floor, Lully strikes his foot. Three months later, Lully died from complications of this self-inflicted wound.
- 1772** The Pine Tree Riot in New Hampshire, a response to British rules about the size of trees that could be cut down, may have inspired the Boston Tea Party a year and a half later.
- 1784** After being denied admission to other Masonic lodges, Prince Hall Freemasonry is founded by Prince Hall in Boston. Still active today, it's the oldest and largest predominantly Black fraternity in the United States.
- 1778** The Cuddeback Spy Ring is formed at the instigation of George Washington. This group of spies, some of whose identities are still unconfirmed, was very successful in relaying information about British troop movements during the American Revolution.
- 1819** Handel's Coronation Anthem No. 1, *Zadok the Priest*, is published in the second volume of *The Old Colony Collection of Anthems Selected and Published Under the Particular Patronage and Direction of the Old Colony Musical Society in Plymouth County and the Handel and Haydn Society* in Boston. Two sets of text are given for Handel's anthem: the first is the text which Handel set, and the second is a Christmas text by Rev. Dr. Gardiner from Boston's Trinity Church.



IN MEMORIAM

# JANET PARKER WHITLA

1931 – 2026

H+H dedicates this weekend's performances of Handel's *Water Music* to the memory of emeritus Board member Janet Whitla.

A trailblazer in many areas of her life, Janet served on the H+H Board for 36 years, including as H+H's first female Board president from 2000-2005. Janet led with intention; as a passionate self-identified servant leader, she had a special joy for connecting with people and helping them realize their full potential. She was a key contributor to the formation of H+H's learning programs and served on committees focused on education, organizational health and sustainability, and the celebration of H+H's bicentennial.

To her work with H+H, Janet brought experience from her 40-year career with the Education Development Center, which she transformed to become one of the world's leading independent health and education research institutions. She also served on the boards of the Cambridge Neighbors, New Bedford Whaling Museum, Cambridge College, the New Bedford Symphony Orchestra, From the Top, and Young Audiences of Massachusetts.

Janet was an artist herself, her medium poetry. She will be greatly missed and fondly remembered for her courage, positivity, generosity of spirit, fabulous dance parties, and infectious laughter.

## PROGRAM NOTES **PATTERNS IN MOTION**

On today's program we dance. At the court of Louis XIV, the Sun King—a nickname related to the monarch's passion for dancing in court productions—ballets were fashionable entertainments. The music accompanying these ballets also became extremely popular, so much so, that suites (collections of dances from the ballets or other staged works) were played as concert pieces. As we will hear in the selections by Jean-Baptiste Lully and Jean-Philippe Rameau, the music that accompanied dancing now becomes music for listening.

This fascination with all things dance also inspired composers beyond France to create suites. George Frideric Handel's *Water Music* never accompanied dancing, yet still allowed those who might have danced a minuet, for example, to recognize its musical characteristics. Even works such as Johann Sebastian Bach's Brandenburg Concerto No. 1 reference dance movements.

### **George Frideric Handel, Coronation Anthem No. 1, *Zadok the Priest***

For the October 1727 coronation of King George II and Queen Caroline, Handel composed four anthems, each of which was to be sung at a different point in the ceremony. *Zadok the Priest*, was sung as part of the Anointing. The clarity of Handel's choral and orchestral writing, particularly with the opening statement, creates a powerful and lasting effect. It is no wonder that this anthem has been sung at every coronation since 1727.

### **Jean-Baptiste Lully, *Le Bourgeois gentilhomme***

At age 14, Giovanni Battista Lully left his home in Florence to be an Italian tutor for Louis XIV's cousin. At court, Lully collaborated with a member of the royal ballet for his first work; this most likely led to him performing in the *Ballet royal de la nuit*, a 13-hour work in which the young Louis XIV danced the role of Apollo. Impressed with Lully's talent, Louis XIV appointed him *compositeur de la musique instrumentale*.

As Lully's fame continued to grow, he began collaborating with one of the great French writers, Molière. They wrote numerous *comédie-ballet*—plays that included dancing, singing, and other music—including *Le Bourgeois gentilhomme*, for which Lully came out of retirement as a performer. It was premiered in 1670, but when the ballet was later staged in Paris, Molière reportedly did not include Lully in the profits—one reason for the two falling out.

*Le Bourgeois gentilhomme* (The Middle-Class Aristocrat) centers around Monsieur Jourdain, whose dreams of becoming a nobleman overshadow everything else. He is tricked into paying another nobleman's debts and refuses to allow his daughter to marry Cléonte, the man she loves, because he is not an aristocrat. Seeing through her husband's

folly, Jourdain's wife helps disguise Cléonte as a Turkish prince. (At this time, the Ottoman Empire was a point of cultural fascination and appropriation in Europe.) Jourdain believes he will also be ennobled in exchange for allowing his daughter to marry this (false) Turkish prince.

### **Johann Sebastian Bach, *The Art of the Fugue* and Brandenburg Concerto No. 1 in F Major**

Bach began working on what would become his *Art of the Fugue* (*Die Kunst der Fugue*), in the 1730s. When he died almost 20 years later this encyclopedic study of imitative writing was still incomplete. His sons published the 17 fugues—which Bach called “contrapunctus”—and 4 canons after his death, along with a chorale prelude. Bach based all of these works on the same theme, a melody defined by its motion from longer to quicker note values.

The solo instruments in Concerto No. 1 in F major, BWV 1046, are two horns, three oboes, bassoon, and violin (*violino piccolo*). The winds (horn, oboe, bassoon) of the solo group might easily overpower a single violin, so for much of the first movement Bach uses the solo violin as the leader of the larger ensemble. In the second movement, the emergence of the violin in dialogue with the oboes and bassoon creates a delightful musical conversation. In the subsequent Allegro, Bach pairs the violin with one horn, then one oboe, before presenting a series of dance movements that feature the soloists.

### **George Frideric Handel, *Water Music***

Handel's *Water Music* was one component in a lavish public event that took place on July 17, 1717. The evening began at Whitehall with the king and his guests travelling by barge to Chelsea for a royal feast; everyone returned early the next morning. A second barge carried the 50 musicians who performed Handel's music. George I was reportedly so pleased with the music, he ordered that it be played three times that evening.

While this is the first known orchestral work in England to include French horns, other musical details about this piece are less certain. The original manuscript is lost; one of the first publications was a 1743 keyboard arrangement, which organized the movements by key (F, D, and G). This arrangement, however, is not reflected in other sources, including the oldest known version—found in 2004—which divided the movements into two rather than three suites.

In this suite, Handel references familiar sounds from across Europe. The Air captures the lyricism associated with Italian (vocal) music. The bright and fast Bourrée was originally a French folk dance of Spanish and Italian influence. The Hornpipe is often associated with England and sailors; however, its long and varied history includes dances that were often named for a particular performer. With its vibrant energy, leaping melodies, and syncopated rhythms, Handel's Hornpipe recalls the virtuosity of these performers.

### **Jean-Philippe Rameau, *Suite of Instrumental dances and overtures***

Little is known about Jean-Philippe Rameau's life until he traveled to Italy at the age of 18 to continue his music studies. He returned to France a few months later, making his living as a violinist and church organist in several cities before settling in Paris in 1722. That same year he published his influential *Treatise on Harmony* which described the relationship between chords in a way that became the foundation of the harmonic system still used today.

When he was 50 years old, Rameau turned to writing stage works. His first opera, the tragedy *Hippolyte et Aricie*, was controversial. Some critics thought the work was innovative and fresh, while others considered it an attack on the traditions established by Lully. The Overture follows a two-part structure popularized by Lully, in which the first part features lilting rhythms and the second an imitative texture.

Rameau follows the same plan for the Overture to his *Les Indes galantes*, which premiered in 1735. Set to a libretto by Louis Fuzelier, *Les Indes galantes* represents one aspect of the 18th-century French world view labeled by Denis Diderot as the “eastern Indies” (the Ottoman Empire) and the “western” (the Americas). Fuzelier's text, a series of scenes, all connected by the overarching theme of love, is critical of the conquest and colonization of the New World.

The two Tambourin dances—characterized by spirited tempos and heavy accents representative of percussion instruments—come at the conclusion of the story titled *Le Turc genereaux* (The Generous Turk). Here, the fate of two captives, who are in love, is changed through the kindness of Osman, their captor.

Rameau's Chaconnes from his operas *Naïs*—commissioned in 1748 to help celebrate the end of the War of Austrian Succession—and *Dardanus*, composed in 1733 at the height of the controversy between supporters of Rameau and those of Lully, each feature variations that increase in rhythmic complexity.

In all these works, we will hear musical figures established and varied within each selection. Many of these were derived from the popular dances of the day. From the growing excitement of the opening of *Zadok the Priest*, to Rameau's elegant Chaconne from *Dardanus*, each work will take us deeper into the patterns, colors, and textures of the Baroque.

### **Teresa M. Neff, PhD**

*Christopher Hogwood Historically Informed Performance Fellow*

## TEXT

### Handel: Coronation Anthem No. 1, Zadok the Priest

Zadok the Priest,  
And Nathan the Prophet,  
Anointed Solomon king;  
And all the people rejoiced, rejoiced, rejoiced  
And said:  
God save the king, long live the king  
God save the king, may the king live forever!  
Amen! Alleluia!



BOSTON  
PHILHARMONIC  
YOUTH ORCHESTRA  
BENJAMIN ZANDER  
CONDUCTOR

**Harbison**  
*Remembering Gatsby*

**Gershwin**  
*Rhapsody in Blue*  
Makoto Ozune piano

**Copland**  
Symphony No. 3



VISIT: BOSTONPHIL.ORG    5/3/26 | SYMPHONY HALL | 7PM    CALL: 617.236.0999



**YOU**  
are the music  
**THE CAMPAIGN FOR H+H**

## **You Are the Music ends June 30. Have you played your part?**

Your donations help us bring **exceptional artists** and inspired programming—like our annual **Emancipation Proclamation Concert** and new high school **Chorale Festival**—to the stage, expand access, and create welcoming experiences for thousands of **new music lovers of all ages.**



There's still time to **ensure the brightest future for H+H with a gift today.**



## ARTIST PROFILES

PHOTO: MARCO BORGREVE



**Jonathan Cohen** conductor

Jonathan Cohen has forged a remarkable career as a conductor, cellist, and keyboardist. Well known for his passion and commitment to chamber music, Jonathan is equally at home in such diverse activities as Baroque opera and the classical symphonic repertoire. He is Artistic Director of the Handel and Haydn Society (H+H), Artistic Director of Arcangelo, Artistic Director of Tetbury Festival, and Artistic Advisor to the London Handel Festival.

During the 2025–26 Season, Jonathan continues to have a strong presence on both sides of the Atlantic. He makes his debuts with Güzernich-Orchester Köln, in a complete performance of Bach's *Weihnachtsoratorium* and Helsinki Philharmonic, in Haydn's *Creation*. Further debuts include Slovenian Philharmonic, BBC Philharmonic, and Tampere Philharmonic. He returns to Orchestre de Liege and Glyndebourne Festival Opera for a new production of Monteverdi *Orfeo*.

Jonathan founded Arcangelo in 2010 to create high quality bespoke projects. The ensemble was the first named Baroque Ensemble-in-Residence at Wigmore Hall, where it enjoys a continuing close association, and has toured to exceptional halls and festivals including Philharmonie Berlin, Vienna Konzerthaus, Barbican Centre, Kölner Philharmonie, Salzburg Festival, MA Festival Bruges, with three appearances at the BBC Proms including the premiere of Handel's *Theodora* (2018) and a televised performance of Bach's St. Matthew Passion (2021). They are Principal Ensemble-in-Residence at the London Handel Festival.

Arcangelo's founding commitment to the recording studio has produced 30 critically lauded albums including Arias for Guadagni and Bach Cantatas with Iestyn Davies (Hyperion; Gramophone Award 2012 and 2017), Mozart Violin Concertos with Vilde Frang (Warner; ECHO Klassik Award 2015), C.P.E. Bach Cello Concertos with Nicolas Altstaedt (Hyperion; BBC Music Magazine Award 2017), Buxtehude Trio Sonatas Op.1 (Alpha Classics; GRAMMY Nominee 2018), Tiranno with Kate Lindsey (Alpha; Sunday Times Records of the Year 2021). Arcangelo's latest recordings include Handel's *Theodora*, *Sacroprofano* with Tim Mead, Handel's Chandos Anthems (Alpha), and a landmark project with Nicolas Altstaedt to make the first survey on period instruments of Boccherini Cello Concertos (Alpha).

PHOTO: GRETJEN HELENE



**Dr. Anthony Trecek-King** conductor

Dr. Anthony Trecek-King is a highly acclaimed choral conductor, scholar, pedagogue, and media personality with a career spanning over 20 years. He is an active guest conductor, serves as a Resident Conductor (chorus) of the Handel and Haydn Society, Artistic Director of the Berkshire Choral International, and a Creative Advisor for the Voces8 US Foundation.

Recognized for his ability to create moving performances that exhibit a surprising range of dynamics and depth of expression, Dr. Trecek-King excels at cultivating vocal and instrumental musicians at all levels. Through his collaborative rehearsal style, he bridges the gap between high art and humanity, captivating audiences while maintaining exceptional sonic quality.

Ensembles under his direction were integral to projects that have won a Pulitzer Prize (*Madam White Snake*, Zhou Long), received a Grammy (*Fantastic Mr. Fox*, Boston Modern Orchestra Project), and earned the National Arts and Humanities Youth Program Award from Presidential Committee on the Arts (Boston Children's Chorus). Dr. Trecek-King has worked with a variety of artists and ensembles including Leslie Odom Jr., Melinda Doolittle, the San Francisco Symphony Chorus, The Houston Chamber Choir, Seraphic Fire, Keith Lockhart, John Williams, Gil Rose, Simon Halsey, Yo Yo Ma, and Roomful of Teeth. He has led performances in world-renowned venues including Boston Symphony Hall, the Kennedy Center in Washington, D.C., Carnegie Hall in New York City, Royal Albert Hall in London, and the Sydney Opera House.

He holds a B.M. in Cello Performance from the University of Nebraska at Omaha, an M.M. in Orchestral Conducting from Florida State University, and a D.M.A. in Choral Conducting from Boston University.

# H+H ORCHESTRA

## Violin I

Aisslinn Nosky<sup>†</sup>  
*Concertmaster*  
*Chair Endowed in Perpetuity by Paul & Rhoda Joss*  
Keats Dieffenbach  
Alyssa Campbell  
Renée Hemsing  
Thompson Wang  
Amelia Sie  
Guiomar Turgeon  
Jane Starkman

## Violin II

Christina Day Martinson\*  
*Associate Concertmaster*  
*Dr. Lee Bradley III Chair*  
Carmen Johnson-Pájaro  
Tatiana Chulochnikova  
Eliana Estrada<sup>‡</sup>  
Rebecca Nelson  
Julie Leven

## Viola

Stephen Goist\*  
*Chair Funded in Memory of Estah and Robert Yens*  
Jenny Stirling  
Emily Eng  
Joy Grimes

## Cello

Guy Fishman\*  
*Nancy & Richard Lubin Chair*  
Sarah Freiberg  
Colleen McGary-Smith  
Sarah Ghandour<sup>‡</sup>

## Bass

Heather Miller Lardin\*  
*Amelia Peabody Chair*  
Peter Ferretti

## Flute

Emi Ferguson\*  
*Chair Funded in Memory of Kate C. Moore*  
Joseph Monticello

## Oboe

Debra Nagy\*  
*Chair Funded in Part by Dr. Michael Fisher Sandler*  
David Dickey  
Mary Cicconetti

## Recorder

David Dickey\*  
Gaia Saetermoe-Howard

## Bassoon

Nate Helgeson\*  
Clay Zeller-Townson

## Horn

Todd Williams\*  
*Grace & John Neises Chair*  
Nathanael Udell

## Trumpet

Jesse Levine\*  
Paul Perfetti  
Greg Gettel

## Timpani

Jonthan Hess\*  
*Barbara Lee Chair in Memory of John Grimes*

## Organ + Harpsichord

Ian Watson\*  
*Chair Funded in Perpetuity in Memory of*  
*Mary Scott Morton*

<sup>†</sup> Concertmaster  
<sup>\*</sup> Principal  
<sup>‡</sup> H+H Stone Fellow

# JOHANN CHRISTIAN BACH

## *Operas and Dramatic Works*

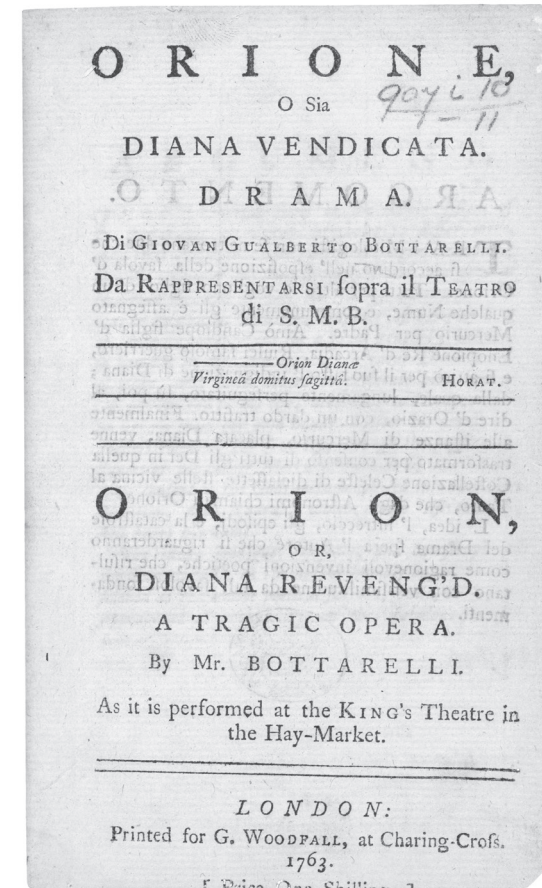

Published by The Packard Humanities Institute  
jcbach.org

HANDEL+HAYDN SOCIETY

# PRIDE '26

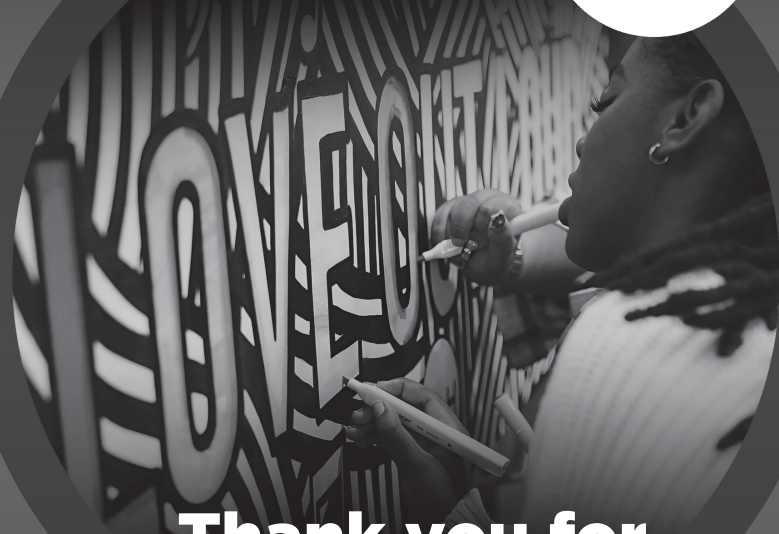

**Thank you for  
celebrating Boston's  
LGBTQ+ community  
with us!**

**WITH THANKS TO OUR  
COMMUNITY PARTNERS**



**CORO  
ALLEGRO**



**NORTH SHORE  
PRIDE**  
BUILDING COMMUNITY WITH PRIDE



**METCO**



City of Boston  
LGBTQ+ Advancement



## H+H YOUTH CHORUSES CHORALE FESTIVAL SINGERS

### Framingham High School

**Ethan Lobenstine** choral director

Brooklyn Adams  
Sanika Agrawal  
Lily Andriole  
Mckenna Belcher  
Serafina Blackwelder  
Kathryn Brown  
Ari Castro  
Norma Cela Caguana  
Zoe Charbonneau  
Ryleigh Derosier

Olivia DiLoffi  
Isabella Edwards  
Lukas Erasquin  
Aiden Fraggos  
Hannah Geller  
Samuel Goldman  
Caroline Larson DiPalma  
Luke Larson DiPalma  
Elina Mehta  
Adeline Morello

Aaron Paiz Chacon  
Camryn Parker  
Gloria Elizabeth Passos  
Declan Pignone  
Samantha Pippos  
Anna Rybalnik  
Maria Sanchez Ramirez  
Luxx Torres  
William Torres Alicea  
Emerson Xavier

### Silver Lake Regional High School

**Kelley DePasqua** choral director

Abigail Amato  
Casey Anderson  
Leanne Arseneau  
Julia Barr  
M'Harla Beauplant  
Catherine Byrnes  
Allison Campbell  
Madelyn Casper  
Sofia Christensen  
Caroline Cortright  
Olivia Crowley  
Mia DeRosa  
Charles Eldridge

Kiera Ethier  
Skyla Ford  
Benjamin Gulinello  
Maeve Hamilton  
Carlee Hocking  
Caroline Jamoulis  
Everett Kinsman  
Grace Lindsay  
Danielle Masterpolo  
Koen Morris  
Craig Nagle  
Brandon Nista  
Harry Ohlson

Maxwell Petrell  
Brady Pflaumer  
Kendall Reilly  
Lincoln Schmidt  
Wilson Slyker  
Destiny Stratton  
Elina Symes  
Carly Taylor  
April Tewksbury  
Lindsey Tuholski  
Tricia Ungechauer

# LIFETIME BENEFACTORS

The following donors have made cumulative gifts and pledges to H+H totaling \$100,000 or more as of February 1, 2026.

## \$10 Million Level

*One Anonymous Donor*

## \$5 Million Level

*One Anonymous Donor*

## \$2.5 Million Level

Willma H. Davis\*  
Philip Gerdine  
Robert N. Shapiro  
*One Anonymous Donor*

## \$1 Million Level

Amy S. Anthony\*  
Barr Foundation  
Alfred & Fay Chandler\*  
Dr. Frank O. Clark & Dr. Lynn DeLisi  
Debbie & Bob First  
Paul C. Joss & Rhoda K. Joss  
George D.\* & Karen S. Levy  
Drs. Janina A. Longtine & Christopher D. Fletcher\*  
Massachusetts Cultural Council  
Michael & Marcy Scott Morton  
Jim & Cathy Stone  
Jane & Wat\* Tyler  
*Three Anonymous Donors*

## \$500,000 Level

William Achtmeyer  
David Elsabee & Lorraine Gilmore  
Todd Estabrook  
Joseph M. Flynn  
Mr.\* & Mrs. Remsen M. Kinne III  
The Klarman Family Foundation  
Joseph G. Mari  
Mary & Sherif Nada  
National Endowment for the Arts  
Scully Family Foundation  
Piroska E. Soos\*  
Jeffrey & Ann M. Thomas  
Nancy & Michael Tooke  
U.S. Small Business Administration  
Judith & Menno Verhave  
Janet\* & Dean\* Whittle  
Wilson Family Foundation  
Ron\* & Jean Woodward  
Christopher R. Yens & Temple Gill  
*Two Anonymous Donors*

## \$250,000 Level

Bloomberg Philanthropies  
The Boston Foundation  
Dr. Lee C. Bradley III\*  
Cabot Family Charitable Trust  
Edmund\* & Betsy Cabot  
Virginia Wellington Cabot Foundation  
Jane & Christopher Carlson  
Mary L. Cornille & John F. Cogan Jr\*  
Anne & David\* Gergen

Mr. & Mrs. John W. Gerstmayr  
Mr. & Mrs. Nicholas Gleysteen  
Graham\* & Ann Gund  
Mr.\* & Mrs. J. Robert Held  
Jane's Trust  
George Frederick Jewett  
Foundation East  
Kingsbury Road Charitable  
Foundation  
Winifred I. Li\* & William P. Oliver\*  
Nancy & Richard Lubin  
Eric Malins\*  
Jane E. Manilych & Prof. W. Carl Kester  
Peter G. Manson & Peter A. Durfee  
Timothy & Deborah Moore  
Betty Morningstar & Jeanette Kruger  
Stephen Morrissey  
The Parker Family Foundation  
Parthenon - EY  
Dana & Carolyn Pope  
John & Janis Raguin  
Timothy & Maren\* Robinson  
The William B. & Bertha E. Schrafft Charitable Trust  
Stanley & Kay Schlozman  
Dr. Kurt & Susan\* Stark  
Seth Sprague Educational and Charitable Foundation  
Stratford Foundation  
Rose-Marie & Eijk van Otterloo  
Matthew A. & Susan B. Weatherbie Foundation  
Lucas Wegmann  
John J. Winkleman Jr.  
*Three Anonymous Donors*

## \$100,000 Level

Mitchell Adams\* & Kevin Smith\*  
Carolyn & William Aliski  
Leo\* & Gabriella Beranek  
Rob & Nancy Bradley  
Julian & Marion\* Bullitt  
Miguel\* & Sheila Canizares  
Louise & Thomas Cashman  
Clark Charitable Trust  
Patricia Collins\*  
Gregory & Anne Crisci  
Elisabeth K. Davis\*  
Tom & Ellen Draper  
BPS Arts Expansion Fund at EdVestors  
Kate S. Flather  
Darcy & Howard\* Fuguet  
James & Melissa Gerrity  
Stephanie Gertz  
Ann & Gordon Getty Foundation  
John W. Gorman\*  
David Greenewalt Charitable Trust  
Janet\* & Henry Halvorson  
Mrs. Sylvia Hammer\*  
Dena M. Hardymon  
Felda Hardymon

Ellen & John Harris  
Hamilton Company Charitable Foundation  
Helena Foundation  
John Hancock Financial Services  
Judith S. Howe  
Paul V. Kelly & Linda Perrotto  
Judith & Mark King  
Max & Selma Kupferberg Family Foundation  
David Landay  
League of American Orchestras  
Miss Wallace M. Leonard Foundation  
Liberty Mutual Foundation  
Linde Family Foundation  
Richard K. Lubin Family Foundation  
Laura M. & Thomas R. Lucke  
Walter H. Mayo\*  
Kathleen McGirr & Keith Carlson  
James F. Millea & Mary Ellen Bresciani  
Anthony & Amy Moosey  
The E. Nakamichi Foundation  
Grace & John Neises\*  
Janet P. Newell\*  
Deborah Munroe Noonan Memorial Fund  
Scott\* & Diane Palmer  
Bessie Pappas Charitable Foundation  
Winifred & Leroy Parker  
Amelia Peabody Charitable Fund  
Mr. & Mrs. J. Daniel Powell  
Judith Lewis Rameior\*  
Brenda Gray Reny  
Elizabeth Reza & Paul Skelly  
Alice E. Richmond & David Rosenbloom  
Art & Elaine Robins  
Michael F. Sandler  
Richard & Mary Scott  
Richard & Eleanor Seamans  
Mr. & Mrs. Stephen A. Shaughnessy  
David C. Snead & Kate Prescott  
State Street Foundation  
Stearns Charitable Trust  
Abbot & Dorothy H. Stevens Foundation  
SVB Private  
Jolinda & William Taylor  
Donald F. Wahl\*  
Thomas & Jane Watt  
David R. Weaver & the James M. Collins Foundation  
The Harold Whitworth Pierce Charitable Trust  
Rawson\* & Marcia Wood  
*Seven Anonymous Donors*

\* Deceased

# ENDOWED CHAIRS + NAMED FUNDS

The Handel and Haydn Society is grateful to the generous donors who have endowed chairs and established named funds to support H+H's educational and artistic programs. If you are interested in a naming opportunity, establishing a fund, or contributing to an existing fund, contact Emily Reed, Vice President of Donor Relations and Partnerships at 617.262.1815 or ereed@handelandhaydn.org.

## Artistic Director

*The Bicentennial Chair*  
*Funded by an Anonymous Donor*

## President and CEO

*Philip and Marjorie Gerdine*  
*President and CEO*

## H+H Chorus

*Funded in Perpetuity by*  
*Jane & Wat Tyler*

## Chorus Leadership

*Cabot Fund for Chorus Leadership is*  
*Endowed in Perpetuity in Memory of*  
*Ned Cabot*

## Concertmaster

*Chair Endowed in Perpetuity*  
*by Paul & Rhoda Joss*

## Principal Second Violin

*Dr. Lee Bradley III Chair*

## Principal Viola

*Chair Funded in Memory of*  
*Etah & Robert Yens*

## Principal Cello

*Nancy & Richard Lubin Chair*

## Principal Bass

*Amelia Peabody Chair*

## Principal Flute

*Chair Funded in Memory of Kate C. Moore*

## Principal Oboe

*Chair Funded in Part by*  
*Dr. Michael Fisher Sandler*

## Principal Horn

*Grace & John Neises Chair*

## Organ

*Chair Funded in Perpetuity in*  
*Memory of Mary Scott Morton*

## Timpani

*Barbara Lee Chair*  
*in Memory of John Grimes*

## Learning Program

*Funded in Perpetuity by*  
*Karen S. & George D. Levy*

## Chorus of Tenors and Basses

*Funded in Perpetuity by*  
*Lucas Wegmann*

## Named Funds

*Amy Anthony Fund for*  
*Community Engagement*

*Marie-Hélène Bernard Endowed Fund*  
*for Excellence*

*Miguel Canizares Fund for*  
*Music Education*

*Harry Christophers Fund*  
*for Artistic Excellence*

*Debbie and Bob First Family Fund*  
*for Community Engagement*

*George Geyer Fund*

*John Grimes Fund*

*Ann and Graham Gund*  
*Endowment Fund*

*Christopher Hogwood Historically*  
*Informed Performance Fellowship*

*Remsen M. and Joan G. Kinne Endowed*  
*Fund for Music Education*

*Robert N. Shapiro Fund for Imagination*  
*and Creativity*

*Wat H. Tyler Jr. Memorial Fund*

*Ronald Woodward*  
*Education Fund*

## Scholarships

*Candace MacMillen Achtmeyer Award*  
*Evangelyna Etienne Scholarship Award*

*Barbara E. Maze Award for Musical*  
*Excellence*

*Susan Rodgers Youth Chorus Scholarship*

# INSTITUTIONAL SUPPORT

## HANDEL AND HAYDN CIRCLE BENEFACTORS

**(\$50,000 and above)**

The Manton Foundation  
Massachusetts Cultural Council  
*One Anonymous Donor*

## BACH CIRCLE BENEFACTORS

**(\$25,000 to \$49,999)**

99.5 CRB/GBH\*  
The Richard & Natalie Jacoff Foundation, Inc.  
Max and Selma Kupferberg Family Foundation

## PLATINUM BENEFACTORS

**(\$10,000 to \$24,999)**

Beaverdale Foundation  
Hamilton Company Charitable Foundation  
George Frederick Jewett Foundation East  
Kingsbury Road Charitable Foundation  
Liberty Mutual Foundation  
Miss Wallace M. Leonard Foundation  
The Ramsey McCluskey Family Foundation  
New England Conservatory\*  
Mattina R. Proctor Foundation  
Seth Sprague Educational and Charitable Foundation  
United Parish in Brookline\*  
WBUR\*

## GOLD BENEFACTORS

**(\$5,000 to \$9,999)**

Main Street Group Foundation, Inc.  
Marble Harbor Investment Counsel, LLC  
The E. Nakamichi Foundation

## SILVER BENEFACTORS

**(\$2,500 to \$4,999)**

The Mollie B. Foley Charitable Trust

## SUPPORTERS

**(up to \$999)**

Boston Family Office  
The Dover Foundation  
Wolf & Company Charitable Foundation

*\* In-kind Donors*

# INDIVIDUAL DONORS

The Handel and Haydn Society is grateful for the generous support of the following individuals who made gifts of \$500 or more to H+H for the 2025-26 Season as of February 1, 2026.

## COMPOSER'S CIRCLE

### Handel and Haydn Circle

**(\$100,000 and above)**

Willma H. Davis\*  
Philip Gerdine  
Anne & David\* Gergen  
Barbara & Amos Hostetter  
Dr. Janina A. Longtine  
Joseph G. Mari  
The Parker Family Foundation  
Emily F. Schabacker  
Stanley & Kay Schlozman  
Dr. Kurt & Susan\* Stark  
Jim & Cathy Stone  
Jeffrey S. & Ann M. Thomas  
Rose-Marie & Eijk van Otterloo  
Kathleen\* & Walter Weld

### Mozart Circle

**(\$50,000-\$99,999)**

Barbara & Herbert\* Boothroyd  
Julia D. Cox  
Debbie & Bob First  
Judith S. Howe  
Karen Secunda Levy  
Timothy & Deborah Moore  
Rebecca Nemser  
Michael & Marcy Scott Morton  
Robert N. Shapiro  
Judith & Menno Verhave  
Jean Woodward

### Bach Circle

**(\$25,000-\$49,999)**

Mary L. Cornille & John F. Cogan Jr\*  
David B. Elsbree & Lorraine Gilmore

David & Anna Goldenheim

David & Janet McCue  
Stephen Morrissey  
Dana & Carolyn Pope  
John & Mary Power  
Elizabeth Reza & Paul Skelly  
Scully Family Foundation  
David Snead & Kate Prescott  
Jane & James Wilson  
Christopher R. Yens & Temple Gill  
*Two Anonymous Donors*

## CONDUCTOR'S CIRCLE

### Platinum Baton

**(\$15,000-\$24,999)**

Jane & Christopher Carlson  
James Deissler  
Joseph M. Flynn  
George Gong & Patricia Kung  
Ellen & John Harris

Daphne Hatsopoulos  
Jane E. Manilych & Prof. W. Carl Kester  
Laura M. & Thomas R. Lucke  
Michael J. Oliveri & Eric A. Aho  
Mr. & Mrs. J. Daniel Powell  
Art & Elaine Robins  
Mic Rosiello & Patricia Mazzucato  
Richard & Mary Scott  
Rosamond B. Vaule  
Elizabeth & Robert Wax  
Matthew A. & Susan B. Weatherbie Foundation  
John J. Winkleman Jr.  
*Two Anonymous Donors*

### Gold Baton

**(\$10,000-\$14,999)**

Carolyn & William Aliski  
Christopher Baldwin & Sally Reyring  
Rhys Bowen\* & Rebecca Snow  
Rob & Nancy Bradley  
Julian Bullitt  
Miguel\* & Sheila Canizares  
Frank Oliver Clark  
Gregory & Anne Crisci  
Tom & Ellen Draper  
James & Melissa Gerrity  
Jonathan & Carrie Hammond  
Karen Hammond & Michael Quattromani  
Dena M. Hardymon  
Felda Hardymon  
Judith & Mark King  
Joan G. Kinne  
Samuel Knight & Anna Whitcomb  
John M. Loder  
Nancy & Richard Lubin  
Diane N. Palmer  
Brenda Gray Reny  
Susan Grose Rioff  
Caroline G. Rutherford  
Richard & Eleanor Seamans  
Eleanor H. Smith & Donald R. Smith Charitable Fund  
Wayne & Kathryn Smith  
Stewart H. Steffey Jr.  
Jolinda & William Taylor  
Nancy & Michael Tooke  
Judie C. Toti  
Jane A. Tyler  
David R. Weaver and the James M. Collins Foundation  
Clifford Wunderlich\* & David Shuckra  
*Three Anonymous Donors*

### Silver Baton

**(\$5,000-\$9,999)**

Graham & Elisabeth Allison  
Peter Banks  
Richard & Carla Benka  
Harold Carroll & Amy Ryan  
Gwijin Choi & Stella Jun  
Nicholas Dials & Dustin Henderson  
Lucinda I. Doran

Kate S. Flather  
James Franklin & Brenda Swithenbank  
Nicholas & Paula\* Gleysteen  
Pamela Goldberg  
Nancy & Bill Hammer  
Jamie Hoyte & Norma Dinnal  
Per & Jan Jonas  
Rhoda & Paul Joss  
Paul V. Kelly & Linda Perrotto  
Katherine A. Kirby  
Claire Laporte  
David & Suzanne Larsen  
Jonathan Loring  
Margaret H. Marshall  
Beth Maynard  
James F. Millea & Mary Ellen Bresciani  
Mary & Sherif Nada  
Nancy Nizel  
Ms. Helyn W. Oatis & Dr. Peter Libby  
Winifred & Leroy Parker  
Harold I. Pratt  
John A. Renner Jr.  
Miyoko P Sato  
Mr. & Mrs. Theodore E. Stebbins Jr.  
Ralph & Christina Sweetland  
Dr. & Mrs. John Tamilio III  
Terry & Michael Taylor  
W. M. Thackston  
Olaf J. Thorp & Margot L. Thorp  
Phyllis Vineyard  
Thomas & Jane Watt  
Janet\* & Dean\* Whittle  
*Four Anonymous Donors*

### Bronze Baton

**(\$2,500 - \$4,999)**

William Achtmeyer  
Steven & Jane Akin  
Elizabeth Alexander  
Reverend Dr. Katharine C. Black & Professor Peter Black  
Cristina Coletta Blau & Peter B. Blau  
Mark C. Brockmeier & Kathleen Silva  
Paul & Wendy Chieffo  
John & Katharine Cipolla  
Todd Estabrook  
Chieh-Min Fan & Stephen Fan  
Irving & Gloria Fox  
Darcy & Howard\* Fuguet  
Robert L. Goldsmith & Kathleen McLissac  
Martin Guay  
Ellen & Tim\* Guiney  
Martin Hall & Sarita Uribe  
Dr. Douglas Horst & Ms. Maureen Phillips  
Elizabeth Keating  
Maryanne King  
David & MaryBeth MacBain  
Kathleen L. McGirr & Keith F. Carlson  
Robert & Jane Morse  
Myra Musicant & Howard Cohen  
Deborah & Charles Peluse  
Petersen Family Fund

Charlene Placido & Peter Goldis  
Paul Rabin & Arlene Snyder  
Timothy & Maren\* Robinson  
Paul & Ann Sagan  
Polly & Arnold\* Slavet  
Stanley & Jody Smith  
John & Jean Southard  
Bauer & Stenberg Family  
David Taylor  
Margaret E. Thomas  
Kristen Vagliardo  
Daniel James Valentine  
Margot T. Young  
*Seven Anonymous Donors*

## MUSICIANS' CIRCLE

### Soloists' Circle

**(\$1,000-\$2,499)**

William & Julia Alexander  
Steven Backhaus  
Sue Bass  
Mary Ellen Bates  
Deborah C. Benson & Frederic Marx  
Marie-Hélène Bernard  
Richard & Mary Kate Bluestein  
Katharine Boden  
Marilyn Brandt  
Diane & John Paul Britton  
Marshall & Jane Brown  
Francisco J. Buot  
Susan Okie Bush  
Katie & Paul Buttenwieser  
James Buttrick  
Frederick Byron  
Edmund & Betsy Cabot Charitable Foundation  
Steve Calvin  
Lauri Carrick  
Melissa P. Chase & K.E. Duffin  
Mr. & Mrs. Robert V Costello  
Gene & Lloyd Dahmen  
Mary H. DeGarmo  
Jeffrey Del Papa & Susan Assmann\*  
The Van Arsdale Dewey Family  
Priscilla H. Douglas  
Bob & Audree Dyson  
Simon & Carolyn Eccles  
Mary K. Eliot  
John M. Emler  
Ken & Alice Erickson  
John & Patricia Folcarelli  
Samuel Forman  
Peter & Deborah Gates  
David & Karen Gaylin  
The Goldenheim Family  
Stanley N. Griffith & Ann E. Schaulfler  
Cynthia Haines & Ed Mueller  
Suzanne & Easley Hamner  
James & Monina Harper  
Georgene & Dudley Herschbach  
Ann Higgins  
William & Lauren Huyett  
Frederick & Cassandra Ilchman  
Patricia & Thomas Johnson  
James & Sarah Joslin

Daniel & Gloria Kearney  
 Barry D. Kernfeld & Sally A.  
 McMurry  
 Jean Kindleberger  
 Judy Larsen & Todd Quinto  
 Holly C. Laurent  
 Beth & Michael Luey  
 Elizabeth Gray MacKay &  
 Hugh MacKay  
 Patricia MacKinnon  
 Laura & Scott Malkin  
 Peter G. Manson & Peter A.  
 Durfee  
 Ursula Matulonis & Jane  
 O'Rourke  
 Stephen J. McCarthy  
 George & Mary McNeil  
 Margaret & Bryan McQuade  
 Amy Meyer  
 Tremont & Susan Miao  
 Jack & Anne Morgan  
 Nina & Marshall Moriarty  
 Ed & Bean Nardi  
 Marie B. Normoyle  
 Nancy Olson  
 Charlotte J. Patten  
 Michael Payne & Jean  
 Carroon  
 Tony & Kitty Pell  
 Bernie & Sue Pucker  
 John Quinn  
 Deirdre Robbins  
 Robert & Catherine  
 Schneider  
 Barbara & Edward Scolnick  
 Kristin & Roger Servison  
 Joan K. Shafran & Rob  
 Haimes  
 Plimpton-Shattuck Fund  
 Mr. & Mrs. Stephen A.  
 Shaughnessy  
 Marilyn Shesko  
 Rebecca A. Silliman M.D.  
 J.K. Skinner  
 Dr. Alan E. Smith & Ms. Leigh  
 Dunworth  
 Tricia Swift  
 John & Donna Sytek  
 Elise Forbes Tripp  
 Dr. & Mrs. Christopher Turner  
 Rik & Elise Tuve  
 Cecily W. Tyler  
 Kristina Watts  
 Holly Safford Weilbrenner &  
 Charles Weilbrenner  
 Christopher M. & Alice White  
 Joan & Jay Wickersham  
 Kenneth Williams & Christine  
 Dutkiewicz  
 Sally Williard  
 Charlan Zhou & Jeff Dike  
*Six Anonymous Donors*

**Chorus Circle**

**(\$500-\$999)**  
 Joseph Aieta, III & Helen  
 Alcala  
 Julia & John Alberta  
 Matthew & Denise Ali

Thomas G. Beauchamp-  
 Arnold  
 Nima Badizadegan  
 Curtis L. Barnes  
 Kathy Barnes & Tim  
 DelGrande  
 Sheryl Battit & Lee Ford  
 John & Molly Beard  
 Alpine & Donald Bird  
 Richard P. Breed III  
 Julie Brown & Zachary  
 Morowitz  
 Lawrence & Kim Buell  
 Elizabeth Campbell  
 Kristian Carr & Jo D. Saffair  
 Holly & William Carter  
 Wendy Chao  
 Dennis Churchman & James  
 Evans  
 John Clippinger  
 Rev. Francis J. Cloherty  
 Jeff & Jennifer Collins  
 Paul Corneilson & Beth  
 Frasso  
 William & Sally Coughlin  
 Frederik & Sophia Crawford  
 Elizabeth Creasey  
 Joan Crosson  
 John & Diddy Cullinan  
 Ann L. Curtis  
 Joel Davidson  
 Jackie Dennis  
 Dean K. Denniston Jr.  
 Donald & Gale Druga  
 Mr. & Mrs. Farquhar  
 Pierre Fleurant  
 Cheryl Flynn  
 Martin & Kathleen Jewell  
 Fogle  
 Carol Fox  
 Karen Fox & William Barrett  
 Sandy Gadsby & Nancy  
 Brown  
 Buzz & Connie Gagnebin  
 Tim & Annie Gerhold  
 Mary & Michael Gimbrone  
 David Glen  
 Elizabeth & Paul Goodrich  
 Mary J. Greer  
 Graham\* & Ann Gund  
 George Halsey & Grace  
 Billings  
 Tricia Harris & Betty Bourret  
 Elizabeth & Henry Harrison  
 Ingrid & Michael Hillinger  
 Kyle Hoepner  
 Frederic G. Hoppin  
 Pamela & Gardner Jackson  
 Ilene & Richard Jacobs  
 Penny Janeway  
 Alan & Barbara Jenkins  
 Kathleen Jick  
 Mary F. Johnson  
 Lauren N. Jones  
 Elizabeth Kaplan & Federico  
 Minoli  
 Daniel J. Lew  
 Ricardo & Marla Lewitus  
 Pooh & Charlie Lockwood  
 Robert E. Lyons

Carol MacKinnon  
 Sarah L. Manooq  
 Peter & Gail Marcus  
 Diana Marsh  
 Lawrence A. Martin Jr.  
 Marilyn McCrory & Dawn Paul  
 Sharon A. Miller  
 Janet Miner  
 Anne Morgan  
 Wesley & Sandra Mott  
 John & Jasmine Murphy  
 Peter & Melissa Nassiff  
 Marjorie & Roger Nastou  
 Margaret & Joseph  
 Newhouse  
 H. Peter Norstrand &  
 Katherine Tallman  
 Julie Helen Otto  
 Ellen Page  
 Pastuszewski Family Fund  
 Daniel Patnaude  
 Mike Peluse & Hannah  
 Weisman  
 Elizabeth & Ervin\* Philipps  
 Matthew & Karen Pierce  
 Alain Pollak  
 Dr. & Mrs. William A. Ribich  
 Kennedy & Susan Richardson  
 Philip Rightmire  
 Catherine Riley & Barbara  
 Werner  
 Shawn Rock  
 Lidia & Jerry Rosenbaum  
 Penny Rossano  
 Michael & Karen Rotenberg  
 Christopher Salvatore  
 Dr. Michael F. Sandler  
 Paula & Steven Schimmel  
 Kiki & Dan Schneider  
 Elizabeth & Russell Schutt  
 Bonnie & Neil Schutzman  
 Phyllis & Larry Selter  
 Liam & Kathleen Seward  
 Lynn & Peter Smiledge  
 Steven & Kay Solomon  
 Elizabeth Spiess  
 John & Sally Staley  
 Gretchen & Dick Stark  
 Robert & Joanna Stavins  
 Michael Steadman  
 Lorraine & Lee Steele  
 Valerie Clair Stelling  
 Sarah Stewart  
 Ralph & Carol Stuart  
 Anne Szymanski  
 Benjamin & Katherine Taylor  
 Patricia Thompson  
 Susan C. Tillman  
 Richard Trant & Anne Morgan  
 Dr. James Vernon  
 Joseph & Sara Volpe  
 Grace J. Wang  
 Kevin Wertheim  
 Lewis Whitehead  
 Kathryn A. Willmore  
 Timothy Witkowski  
 David & Evelyn Yoder  
*Ten Anonymous Donors*



# Bach + Telemann

MAY 15 + 16

# Voices Carry

MAY 29 + 31

## HANDEL+HAYDN SOCIETY

### UP NEXT

**HHYC SPRING CONCERT**  
 SUN, MAY 17, 5:00PM

**HIGH SCHOOL SOLOISTS SPRING RECITAL**  
 SUN, JUNE 10, 5:00PM



## HANDEL+HAYDN SOCIETY YOUTH CHORUSES



## 1815 SOCIETY

The Handel and Haydn Society thanks the following donors for including H+H in their long-term financial and estate plans as of March 18, 2026.

William Achtmeyer  
Mitchell Adams\*  
Connelly Akstens  
Amy S. Anthony\*  
Marie-Hélène Bernard  
Dr. John D. Biggers\*  
Herbert\* & Barbara  
Boothroyd  
Dr. Lee C. Bradley III\*  
Rob & Nancy Bradley  
Rev. Mark Brockmeier & Dr.  
Kathleen Silva  
Rev. Thomas W. Buckley\*  
Julian Bullitt  
James Buttrick  
Miguel\* & Sheila Canizares  
Margaret P. Cardozo  
Christopher T. Carlson  
Jane Fisher Carlson  
Louise & Thomas Cashman  
Fay Chandler\*  
Melissa P. Chase & K. E.  
Duffin  
Harry Christophers  
Dr. Frank O. Clark  
Christine Coakley & Michelle  
O'Connell  
Patricia Collins\*  
David & Randi Conley  
Richard & Barbara Corkey  
Paul Corneilson  
Robert Cotta  
Paul Cousineau\* & Patricia  
Vesey-McGrew  
Gregory & Anne Crisci  
Willma H. Davis\*  
Mary Deissler\*  
Jeffrey Del Papa  
Lilee Dethchan-Beltran  
Carolyn & Forbes Dewey  
Lucinda Doran  
David B. Elsbree  
Todd Estabrook  
Debbie & Bob First  
Stephen J. Fitzsimmons  
Joseph M. Flynn  
Mr. Takashi Fukuda & Dr.  
Janet Codley  
Drs. Philip & Marjorie\*  
Gerdine  
Anne & David\* Gergen

John & Pamela Gerstmayr  
John W. Gorman\*  
D. J. Griffith  
Nancy & Bill Hammer  
Roy A. Hammer\*  
Dr. Elma Hawkins  
Thomas Frederick Hindle\*  
Dr. Douglas Horst & Ms.  
Maureen Phillips  
Beth F. Houston & Karl W.  
Gerds  
Frederick & Cassandra  
Ilchman  
Paul C. Joss & Rhoda K. Joss  
Jane E. Manilych & Prof. W.  
Carl Kester  
Judith & Mark King  
Phyllis Klein  
Paul Krueger & Charles  
Mallard\*  
Kathryn Kucharski  
David Kurdzionak  
Michael Lawler  
Barbara Lee\*  
Karen S. Levy  
Signe Lindberg  
Dr. Holger M. Luther  
Robert Macauley  
Eric Malins\*  
Peter G. Manson & Peter A.  
Durfie  
Joseph G. Mari  
Franklin J. Marryott\*  
Kathleen McGirr  
James F. Millea & Mary Ellen  
Bresciani  
Janet Miner  
Anthony T. Moosey  
Stephen Morrissey  
Mary & Sherif Nada  
Rebecca Nemser  
Janet Newell  
Michael J. Oliveri  
Barbara Goodwin Papesch\*  
Connie B. Pawelczak  
Mike Peluse  
Thomas Perry\*  
Dana & Carolyn Pope  
Judith Lewis Rameior\*  
Frederick S. Reis\*  
Brenda Gray Reny

Barbara Werner & Catherine  
Riley  
Art & Elaine Robins  
Timothy & Maren\* Robinson  
Robert Rowe  
Lois C. Russell  
Clifford & Judith Rust  
Holly Safford Weillbrenner  
Margaret A. Sagan & Michael  
Simons  
Dr. Michael F. Sandler  
Mr. Michael Scott Morton  
Richard Seamans & Eleanor  
Mulvaney  
Robert N. Shapiro  
Janet K. Skinner  
David C. Snead  
Piroska E. Soos\*  
Drs. Robert G. Spiro\* & Mary  
J. Spiro  
Ms. Rheua S. Stakely\*  
Margaret Stanley\*  
David & Sharon Steadman  
Barbara Stedman  
Wheeler Thackston  
Olaf J. Thorp & Margot L.  
Thorp  
Rodrigo Trevino  
Richard & Elise Tuve  
Eric Malins\*  
Jane & Wat\* Tyler  
Koen\* & Bartha\* van Opijnen  
Judith & Menno Verhave  
Donald F. Wahl\*  
Ruth Ann Walker\*  
Elizabeth & Robert Wax  
Susan B. Weatherbie  
Lucas Wegmann  
Kathleen\* & Walter Weld  
Marion Westgate  
Janet\* & Dean\* Whitla  
John J. Winkleman Jr.  
Rebecca Nemser  
Janet Newell  
Jean Woodward  
Clifford Wunderlich\*  
*Thirteen Anonymous  
Members*

\* Deceased



“H+H has benefited greatly from its long-established 1815 Society, including donors committed to a wide array of planned gifts—estate or trust bequests, beneficiary designations of retirement plans, and other planned giving structures. We all share a devotion to Baroque and Classical music, to original instrument performance. Everyone who feels this musical magic should be able to attend and enjoy H+H performances and programs.”

— Rob Shapiro



## JOIN THE 1815 SOCIETY. SUSTAIN A LEGACY.

Inspired by the *You Are the Music* campaign, former H+H Board Chair Rob Shapiro made an additional planned gift through his estate and is inviting fellow patrons to help secure H+H's future alongside him. By June 30, we aim to welcome 10 new members into the 1815 Society with confirmed planned gifts of \$50,000 or more. When you let us know you've included H+H in your estate plans, you're making a lasting statement about the music you love.

Contact **Marion Westgate** at [mwestgate@handelandhaydn.org](mailto:mwestgate@handelandhaydn.org) or **617.262.1815** with questions or to join the 1815 Society.

**SCAN THE  
QR CODE  
TO LEARN  
MORE**



# HANDEL+HAYDN SOCIETY

JONATHAN COHEN ARTISTIC DIRECTOR

# HANDEL AND HAYDN SOCIETY

## BOARD

### Board of Governors

Judith K. Verhave  
Chair

Deborah S. First  
Vice Chair

Karen S. Levy  
Vice Chair

Michael Oliveri  
Treasurer

Elizabeth Reza  
Secretary

Robert H. Scott  
Acting President

William Achtmeyer  
Dr. Teresa Cachero

Dr. Holly Maze Carter

Dr. Frank Clark

Gerard Cox

Julia D. Cox

Lucinda Doran

Philip V. Gerdine

Pamela Goldberg

Ellen Harris

James S. Hoyte

Patricia Kung

Joseph Mari

Dr. Stephen Morrissey

Michael Scott Morton

Carolyn Pope

Brenda Gray Reny

Arthur G. Robins

Mic Rosiello

George Sacerdote

Robert N. Shapiro

Elizabeth P. Wax

David Weaver

Jean Woodward

Christopher R. Yens

### Governors Emeriti

Todd Estabrook

Joseph M. Flynn

Nicholas Gleysteen

Mary Nada

Timothy C. Robinson

### Board of Advisors

Carrie L.T. Hammond

Nicholas Dials  
Co-Chairs

Cristina Blau

Julian G. Bullitt

Jane Carlson

David Elsbree

Melissa D. Gerrity

Nancy Hammer

Suzanne Hamner

Frederick Ilchman

Lauren Jones

Paul V. Kelly

W. Carl Kester

Mark A. King

James F. Millea

Nancy Nizel

Helyn Oatis

Dr. Winifred B. Parker

Prema P. Popat

Catherine Powell

Emily F. Schabacker

Richard F. Seamans

Dr. John Tamilio III

Dr. Terry G. Taylor

Jeffrey S. Thomas

Cecily W. Tyler

Kristen Vagliardo

Jane Wilson

John Winkleman

# HANDEL AND HAYDN SOCIETY

## STAFF

David Goldenheim  
Acting CEO

Wesley Farnsworth  
Executive Assistant and  
Relationships Manager

### Artistic

Conducting staff and  
programming consultant are  
listed on page 5.

Ira Pedlikin

Vice President of Artistic Planning  
and Concert Production

Jon Linker

Senior Manager, Concert  
Operations and Booking

Jason Fisher

Orchestra and Chorus Personnel  
Manager

Joe Monticello

Music Librarian

### Administration

Lindy Noecker

Senior Manager of Archives and  
Administration

Jandeirvy Sous

Bookkeeper

Kenneth Ngo

Data and Reports Analyst

Ropes & Gray, LLP  
Counsel

KLR

Auditors and Tax Preparers

### Development

Emily Reed

Vice President of Donor Relations  
and Partnerships

Marion Westgate

Major and Planned Giving Officer

Caitlin Seitz

Major and Institutional Giving  
Officer

Keith Supko

Development Operations Manager

Brandie Garcia

Annual Fund and Partnerships  
Coordinator

### Marketing +

#### Communications

Sarah L. Manoog

Vice President of Marketing  
and Communications

Chris Petre-Baumer

Director of Marketing and Creative

Joseph Sedarski

Marketing Manager

Susan Baranyi

Public Relations and Program  
Book Manager

Jo-B Sebastian

Graphic Designer

### Patron Experience

Joanna Springer

Director of Patron Experience

Merrick Carter-Taylor

Ticketing Operations Manager

Laurin Stoler

Calling Campaign Manager

Jerry Waldman

Assistant Calling Campaign  
Manager

Ben Lipkowitz

Telesales Representative

### Learning

Youth Choruses conductors are  
listed on page 5.

### Administration

JongHun Kim

Director of Learning Programs

Luisana Ramirez

Coordinator of Learning Programs

Teresa M. Neff, PhD

Christopher Hogwood Historically  
Informed Performance Fellow

### Associate Conductors

Andrew Milne

HHYC Chorus of Sopranos + Altos  
and Chamber Choir

Becca Crivello

HHYC Youth Chorale and  
Concert Choir

### Musicianship Faculty

Matthew Buono

Lead Musicianship Teacher

Mary Kray

Dr. Hexing Ouyang

Olivia Rich

### Collaborative Pianists

June Chen

Leona Cheung

Dr. Pei-yeh Tsai

Kim Whitehead

### Vocal Pedagogy Specialist

Hannah Klein

List current as of March 2026.

# SYMPHONY HALL INFORMATION

**Accessibility:** Elevator access to Symphony Hall is available at both the Massachusetts Ave and Cohen Wing entrances. An access service center and accessible restrooms are available inside the Cohen Wing.

**Large print programs** are available at the Patron Information table in the lobby.

**Assistive listening devices** are available. Please see the head usher for details.

**Late seating:** Those arriving, or returning, to their seats late will be seated at the discretion of the management.

**Lost and found** is located at the security desk at the stage door on St. Stephen Street.

**Lounge and bar service:** There are two lounges in Symphony Hall: The O'Block/Kay Room on the orchestra level and the Cabot-Cahners Room in the first balcony. Each serves drinks starting one hour before each performance and during intermission.

**Coatrooms** are located on the orchestra and 1st balcony levels and in the Cohen Wing.

**Ladies' rooms** are located in both main corridors on the orchestra level, at both ends of the first balcony and in the Cohen Wing.

**Men's rooms** are located on the orchestra level near the elevator, on the first balcony, and in the Cohen Wing.

**All gender restroom** is located on the first balcony level, near the Beranek Room.

**Break Room:** We welcome patrons and families who wish to take a break during the performance to the Cabot-Cahners Room, located in the rear of the first balcony (Huntington Ave. side). Here you may watch and listen to the performance on TV screens.

**In case of emergency:** Patrons will be notified by an announcement from the stage. Should the building need to be evacuated, please follow any lighted exit sign to the street or follow alternate instructions as directed. Do not use elevators. Walk, do not run.

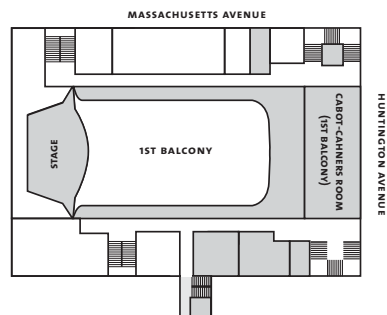
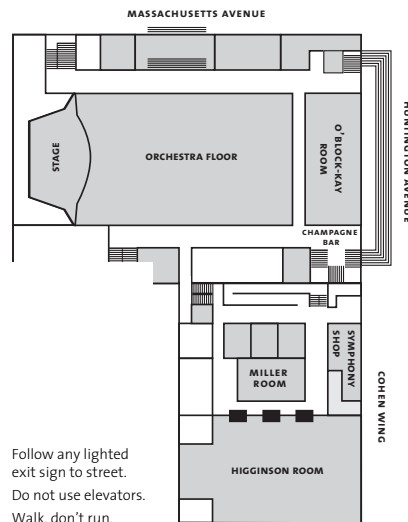

# HANDEL AND HAYDN SOCIETY GENERAL INFORMATION

9 Harcourt Street  
Boston, MA 02116  
handelandhaydn.org

**Administrative Office**  
Monday-Friday, 10:00am-4:00pm  
617.262.1815  
hello@handelandhaydn.org

**Box Office**  
Monday-Friday, 10:00am-5:00pm  
617.262.1815  
boxoffice@handelandhaydn.org

**Group Tickets**  
Groups of 10 or more save 20%.  
Reserve your group tickets at  
groups@handelandhaydn.org

**Musically Speaking**  
Join Historically Informed Performance Fellow Teresa Neff for an engaging exploration of the music and instruments featured in concert.

Talks begin 1 hour prior to concerts at Sanders Theatre and 45 minutes prior to concerts at NEC's Jordan Hall and Symphony Hall.

**Musically Speaking Locations**  
Sanders Theatre: on stage  
NEC's Jordan Hall: Williams Hall  
Symphony Hall: Higginson Hall

**Merchandise**  
H+H offers gift items and recordings featuring our Orchestra and Chorus, along with guest artists throughout the season. Your purchases help support our education and artistic programming.

**Shop Locations**  
Symphony Hall: At the base of the staircase on the left side of the hall (Orchestra Level)

NEC's Jordan Hall: Lobby

APRIL 25 | WGBH STUDIOS

**In the Making: *Land of the Northern Frog***

Featuring Martin Kuuskmann, bassoon  
Music by Lembit Beecher

A FAR CRY  
2025/26  
Season  
AFARCRY.ORG

*Boston Early Music Festival* LEARN MORE AT **BEMF.org**  
PAUL O'DETTE & STEPHEN STUBBS, Artistic Directors

**SATURDAY, APRIL 25 | 8PM**  
ST. PAUL CHURCH, CAMBRIDGE, MA

**PHILIPPE JAROUSKY & ARTASERSE**

*Italian Baroque cantatas exploring the passion and anguish of jealousy with a superstar countertenor*

**SUNDAY, APRIL 26 | 8PM**  
VIRTUAL PREMIERE ON BEMF.ORG

**JORDI SAVALL & FRIENDS**

*Explore how music served as a tool of faith, resistance, and survival through centuries of global transformation.*

**Boston Symphony Orchestra** Andris Nelsons  
Music Director

**where music lives**

**Tickets available now at [bso.org](https://www.bso.org)**

What does it mean to unite many voices into one story? This January, the BSO explores the history and diversity of America's music. Andris Nelsons leads Samuel Barber's *Vanessa*, a hauntingly romantic opera presented in collaboration with Boston Lyric Opera. Pianist Seong-Jin Cho shines in Tchaikovsky's First Piano Concerto alongside Bernstein's *Chichester Psalms* and Allison Loggins-Hull's *Rhapsody on a Theme by Joni*.



# 2026-27 SEASON

**The Art  
of Living**

Oct 2 + 4

**Handel's  
*Messiah***

Nov 27 + 28 + 29

**Baroque  
Christmas**

Dec 17 + 20

***Kiss and Tell:*  
A World Premiere**

Jan 29 + 30

**Brandenburg  
Concertos**

Feb 19 + 21

**Beethoven's  
Fifth**

Mar 19 + 20

**Haydn in  
Plain Sight**

Apr 2 + 4

**Mendelssohn's  
*Elijah***

May 1 + 2



---

**HANDEL+HAYDN SOCIETY**

**JONATHAN COHEN** ARTISTIC DIRECTOR

[handelandhaydn.org](http://handelandhaydn.org)

617.262.1815

PHOTO BY ROBERT TORRES